

A large, faded version of the "Mission 2020" logo is centered in the background. It features an orange globe and the text "reach • teach • serve" at the top, "mission 2020" at the bottom, and "CICERO CHRISTIAN CHURCH" on the right side.

**Jerusalem**  
**Spotlight on:**  
**The Children's Center**

**Questions & Answers**



## **Why do we need a Children's Center?**

A Children's Center would allow proper space for a growing ministry. Currently much of the Children's Ministry space is being shared with other ministries. The result is that events like Kid's Church must be set up and taken down every time and the environment does not possess the same effect that a more permanent space would provide.



## **Who can use it?**

The primary use of the Children's Center would be for ages 4 through grade 5, but it would not have to be exclusive to the Children's Ministry. The space does have the potential to be used for drama events, special church services or events and other possibilities.



## **How do we fund it?**

Right now options are being explored. This project is not a budget item and is not designed to put CCC further into debt.

Where in the process are we?

We are in the very beginning stages. Ben Radant is assembling a team to help him with this project. Preliminary ideas for the center have been drawn up and are being looked at.



## **How can I get involved?**

- Pray: This cannot be accomplished without being bathed in prayer. Pray for the team, the funds and that God would open all the doors necessary to open the doors to the Children's Center.
- Be a Team Member: There are spots open to be heavily involved with the process of making the Children's Center a reality.
- Funding: Ultimately there will need to be funds to make this happen. If you have any ideas we'd love to hear them. If you wish to give financially there will be a cash account set up for the Children's Center.



## **What will it look like?**

On the back of this pamphlet is a first glance look at what the center might look like. Please note that it is not a professional drawing. It also most certainly will change as it has not been looked at by a contractor or planner.

Some features of this drawing include:

- A central Check-In area for ages 4 through 5th grade.
- Bathroom access to the back half of the building.
- An elevator that will access the adult classrooms and upper part of the Children's Center.
- A new kitchen.
- An open loft area that would allow children to build relationships and have fun.
- A new office for Mephibosheth if their building is not open by the time this is built.

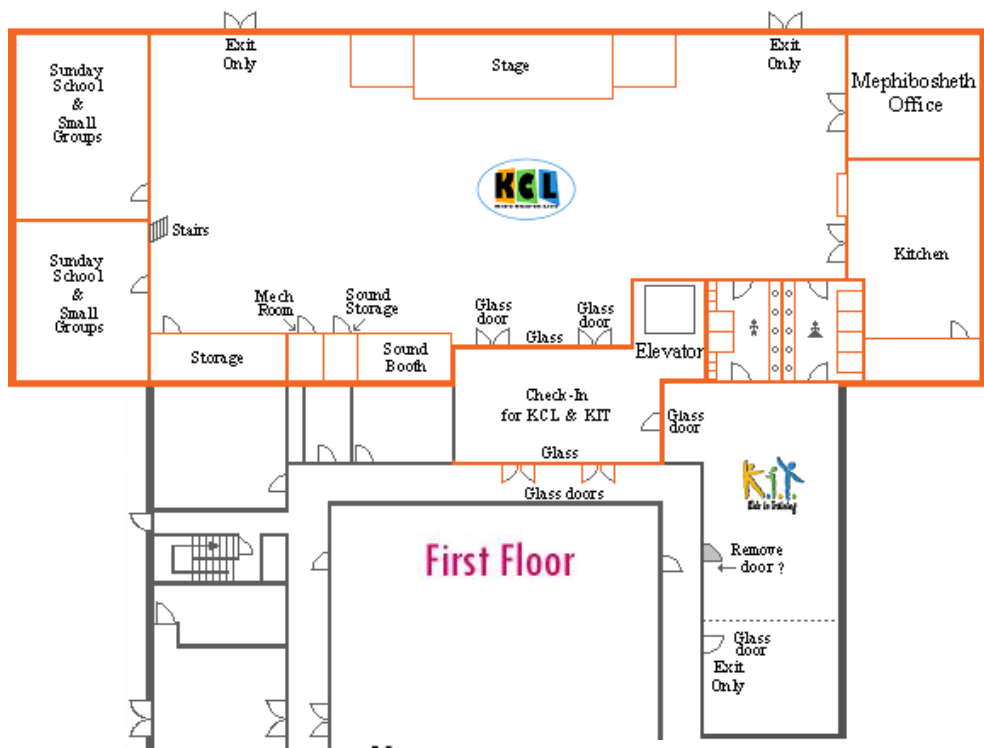

**Key:**

= New Addition

= Existing Building

